

Parts List for Model 8120

| Item No. | Qty. | Part Number | Description |
|-----------------|-------------|--------------------|---------------------------------------|
| 1 | 1 | 71-1265 | Ring for Model 8120 |
| 2 | 1 | 8120K-01 | Vane Kit; 4 Vanes, 1 Gasket |
| 3 | 1 | 71-1257 | End Plate |
| 4 | 1 | 71-1258 | Sound Chamber |
| 5 | 1 | 71-1259 | Gasket |
| 6 | 1 | 71-1260 | Shroud |
| 7 | 2 | 71-1261 | Filter Kit; 4 Felts, 1 Ring, 1 Holder |
| 8 | 1 | 71-1268 | Exhaust Assembly |
| 9 | 1 | 71-1267 | Intake Assembly |
| 10 | 2 | 71-1275 | Filter Jar |
| 11 | 2 | 71-1270 | Filter Element |
| 12 | 2 | 71-1269 | Filter Jar Gasket |
| 13 | 2 | 62-0337 | Brass Nipple |
| 14 | 1 | 71-1357 | Carbon Wear Plate |
| 15 | 1 | 71-1358 | Felt Washer |

Exploded View of Model 8120

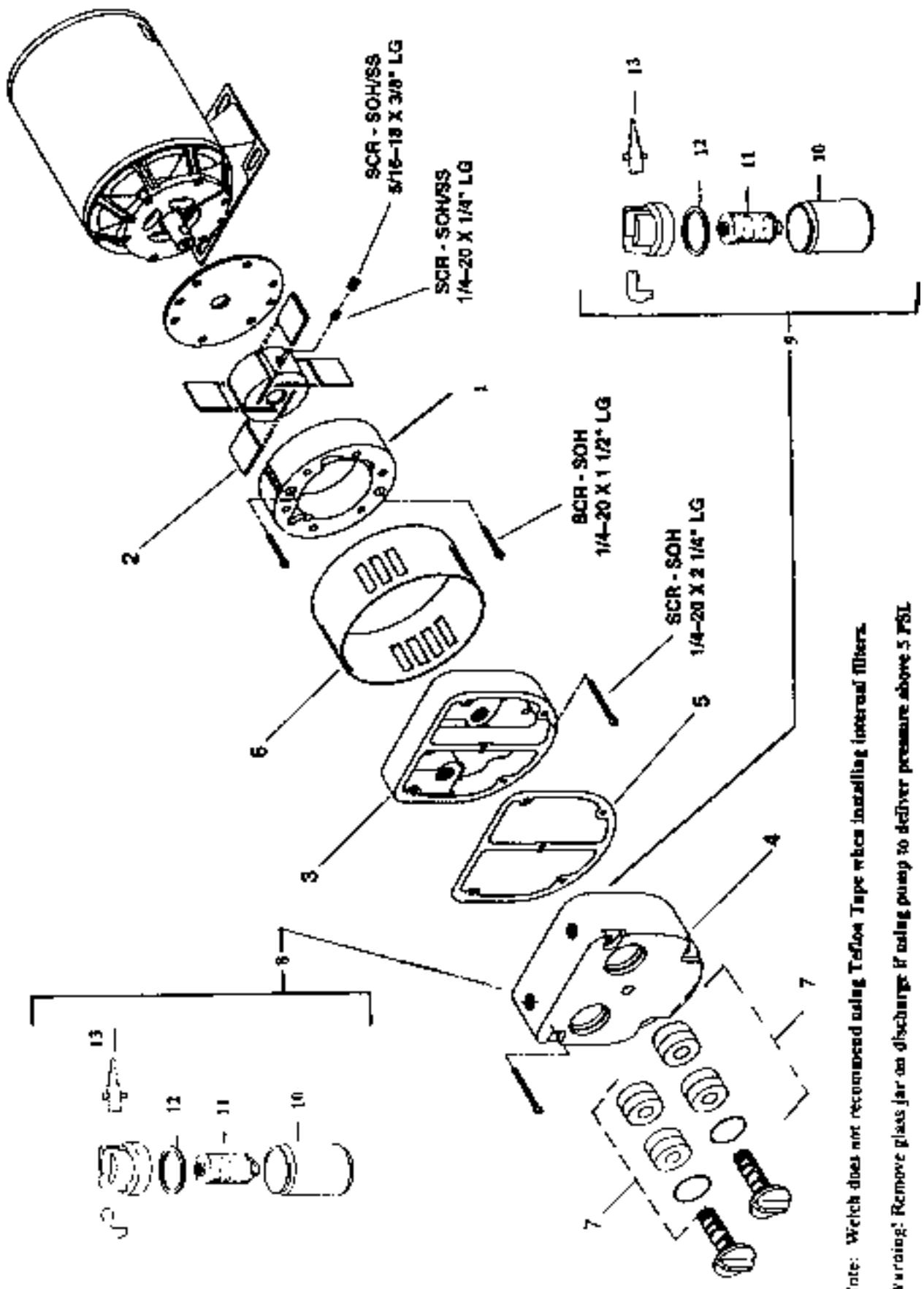

Note: Welch does not recommend using Teflon Tape when installing internal filters.

Warning: Remove glass jar on discharge if using pump to deliver pressure above 5 PSI.